

Installation procedure:

1. Connect the HDMI and USB ports of the receiver of the wireless transmitter to the display device such as the TV or projector.
2. Connect the HDMI and USB ports of the transmitter of the wireless transmitter to the display device such as laptops, desktops, set-top box cameras, and camcorders.
3. After the connection is complete, the blue light of the transmitter will blink first, and becomes steady. When the connection is successful, the screen will show the video.

Note:

1. Equipment operating temperature: About 50 degrees ,but it is normal temperature which does not affect the use.
2. The device has been paired before leaving the factory, and the user does not need to re-pair.
3. The RX light at the receiving end will not flash and only serves as a power indicator light

Wireless Transmitter Pairing Method

Pairing Steps

1 Receiver side

- (1) Connect the receiver USB port to the USB power supply or device with USB port
- (2) Connect the receiver HDMI port to the display device
- (3) use a paperclip to press the reset button on HDMI side of the receiver for about 2 seconds (not so long), wait for the screen to display "Release the button to pair with Mate" then immediately release the button



2 Transmitter side

- (1) Connect the transmitter USB port to a USB-powered device, and wait for the screen to display "Ready to pair".
- (2) Use a paperclip to insert the pairing/reset hole at the HDMI end and press the pairing button for 5 seconds, wait until the signal light goes off and release the button.
- (3) Then wait for the screen to show "√" to indicate successful pairing.



Attention:

The reset hole on the receiver side of the wireless transmission has two setting modes depending on the pressing time.

- (1) Press and hold for 2 seconds: open the pairing mode of the receiver for pairing with the transmitter, so the pairing pairing can not be pressed for too long
- (2) long press 10 seconds: the receiver back to the original factory settings.

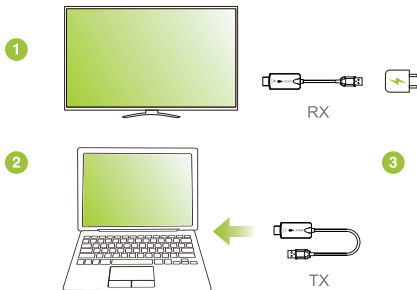

安装步骤:

1. 将无线传输器接收端HDMI和USB端口连接至电视机或者投影仪等显示设备
2. 将发射端HDMI和USB端口接上笔记本电脑、台式机、机顶盒、相机、摄像机等信号源
3. 接好后发射端蓝灯先闪烁，连接成功后变常亮，屏幕出现图像

注意事项:

1. 设备工作温度：50 度左右，属于正常温度不影响使用
2. 设备出厂前已配对好，在不能使用的情况下，再重新配对
3. 接收端灯不会闪烁，仅作电源指示灯

无线传输器配对方法

配对步骤

1 接收端

- (1) 将无线传输器的接收端的USB端连接至USB供电或设备USB接口。
- (2) 将无线传输器的接收端HDMI接上显示设备
- (3) 使用回形针长按接收器HDMI端的重置孔配对按键2秒左右（不能按时间太长），等待屏幕显示Release the button to pair with Mate时马上放开按钮



2 发射端

将发射器USB口接上USB供电设备，等在屏幕上显示“Ready to pair”时，使用回形针插入位于HDMI端的配对/重置孔配对按键长按5秒，待信号灯熄灭关闭按键，等待屏幕出现打“√”表示设备配对成功。



注意:

无线传输接收端上的重置孔，根据按压时间不同，有两种设定模式。

- (1) 长按2秒：开启接收器的配对模式，供与发射器进行配对，所以配对不能按时间太长
- (2) 长按10秒：将接收器回复原厂设定。